

1 HANDRAIL AND FOOTING DETAILS
SECTION
Scale 1:20

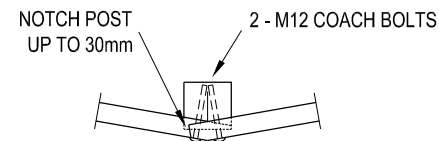

2 HANDRAIL CONNECTION AT POST
PLAN
Scale 1:20

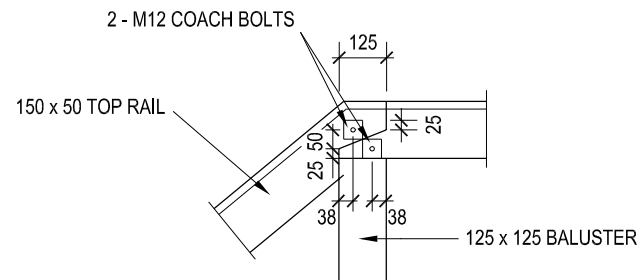

3 HANDRAIL CONNECTION AT POST
ELEVATION
Scale 1:20

NOTES

- TIMBER GRADE:**
-ALL TO BE G8 OR BETTER.
- TIMBER TREATMENT:**
-ROUND OR SAWN PILES OR POLES IN CONTACT WITH GROUND TO BE H5.
-SAWN TIMBER NOT IN CONTACT WITH GROUND TO BE H5.
-TREATMENT SHALL COMPLY WITH THE CURRENT REQUIREMENTS OF THE TIMBER PRESERVATION COUNCIL. ALL TIMBER SHALL BE BRANDED WITH THE APPROPRIATE WOODMARK. IT IS PREFERRED THAT TIMBER BE TREATED AT LEAST 2 MONTHS PRIOR TO USE.
- BOLTS:**
-BOLTS SHALL BE M12 HOT DIPPED GALVANISED ENGINEERS BOLTS FITTED WITH 50 x 50 x 5 GALVANISED SQUARE WASHERS BOTH ENDS. ALL GALVANISED BOLTS IN CONTACT WITH TREATED TIMBER SHALL BE PROTECTED USING GP GREASE IN PRE-GREASED HOLES.
-IN MARINE SPRAY LOCATIONS USE 316 STAINLESS STEEL.